

Project:		Catalog#:		Type:	
Prepared By:		Notes:		Date:	

## E4DL

LED Commercial Downlight  
• CCT-selectable • 5 Year Limited Warranty



### Overview

Energetic Lighting's E4DL series is suitable for use in a broad range of commercial applications. Available in 4 profile sizes from 4", 6", 8", covering almost any application project. Utilizing today's latest innovative LED solutions and technologies paired with world class manufacturing. The E4DL series is a great choice for renovation opportunities replacing existing commercial downlight fixtures or for new construction projects that require code compliant energy saving LED solution. Ideally suited for office spaces, schools, retail, hospitality and healthcare.

### Features

- Ez-CCT: Selectable 3000K, 3500K, 4000K
- Suitable for use in Type IC and Non-IC recessed location
- Suitable for Damp location
- 120-277V
- Dimmable with Phase Dimming of Triac @ 120V

### Applications

- Residential and Multi-family
- Commercial and Retail
- Office and Hallway
- Healthcare and Hospitality
- General Indoor Area



### Highlights



Field-selectable CCT and wattage control provides flexibility to installation and Stocking



Universal spring clip arms allows direct mounting to surface without need for recessed can housing

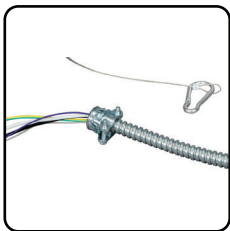

Flexible metal conduit lead with 1/2" trade-size knockout adapter; safety cable also provided



Stepped baffle trim for optical diffusion and modern aesthetic design

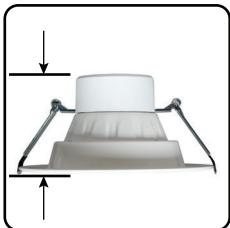

Without the need for a recessed can housing, the plenum height needs only accommodate the downlight body height

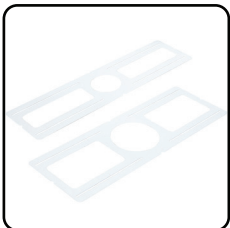

Optional Rough-in plates available in 4", 6", 8" downlight diameter

### Load Information

Input Voltage	120-277Vac	
Power Factor	>0.7	
THD	20%	
Low Temp Start	-4°F	
Max Temp	104°F	
Unit Weight	4"	1 lbs
	6"	1.4 lbs
	8"	2 lbs

### Shipping Information

Item	Weight	Box Qty.
4"	7 lbs	6 per case
6"	10 lbs	6 per case
8"	13 lbs	6 per case

### Lumen Maintenance

Housing Type	Ambient Temperature	TM-21 Lumen Maintenance (50,000 hours)	Theoretical L70 (hours)
4" Smooth	25°C	>78%	54,000
6" Smooth	25°C	>78%	54,000
8" Smooth	25°C	>78%	54,000

### Dimensions

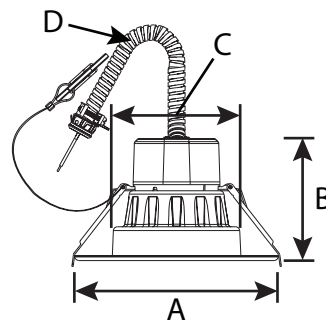

Description	Dim	Model profile		
		4" profile	6" profile	8" profile
Front diameter (thru-hole upper limit diameter)	A	5.8"	8.3"	10.2"
Overall Height	B	3.7"	4.0"	4.3"
Min thru-hole diameter	C	3.6"	5.8"	7.2"
Conduit overall length	D	24"	24"	24"

## Model Ordering Number Breakdown

Series Prefix	Housing Size	Lumens	CRI	CCT
<b>E4DL</b>	<b>4N</b>	<b>11</b>	<b>E8</b>	<b>3040</b>
<b>E4DL</b> Energetic LED Downlight CCT-selectable	<b>4N</b> 4" Smooth <b>6N</b> 6" Smooth <b>8N</b> 8" Smooth	<b>8</b> 800lm <b>11</b> 1100lm <b>17</b> 1700lm <b>11</b> 1100lm <b>17</b> 1700lm <b>21</b> 2100lm	<b>8</b> 80 CRI	<b>3040</b> 3000K, 3500K, 4000K

## STOCK ORDER INFORMATION

### CCT Selectable Profile Triac @ 120V

Model Number	Order#	Lumens	Wattage	LPW	Color Temp	CRI	Voltage	Dimming	DLC	Pallet Qty
E4DL4N8E83040	50041	750LM	9W	83	3000   3500   4000k	80	120-277V	Triac	Energy Star	TBA
E4DL6N11E83040	50042	1100LM	13W	85		80	120-277V	Triac	Energy Star	300
E4DL6N17E83040	50043	1650LM	18W	92		80	120-277V	Triac	Energy Star	180
E4DL8N11E83040	50044	1100LM	13W	85		80	120-277V	Triac	Energy Star	180
E4DL8N17E83040	50045	1650LM	18W	94		80	120-277V	Triac	Energy Star	180
E4DL8N21E83040	50046	2100LM	22W	95		80	120-277V	Triac	Energy Star	180

### Optional Accessories

#### E1RIP-4

Rough-in plate for 4" downlights

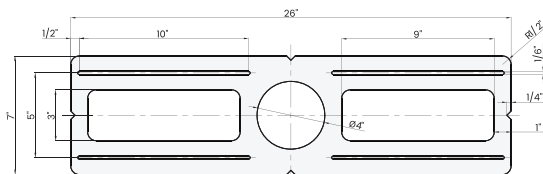

#### E1RIP-6

Rough-in plate for 6" downlights

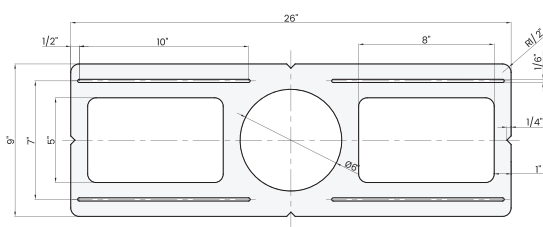

#### E1RIP-8

Rough-in plate for 8" downlights

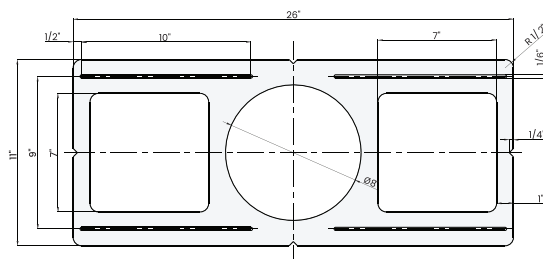



**ENERGETIC**<sup>®</sup>  
L I G H T I N G

**E4DL**

LED Commercial Downlight CCT-selectable  
50,000 System Lifetime • 5 Year Limited Warranty

**NOTES:**