

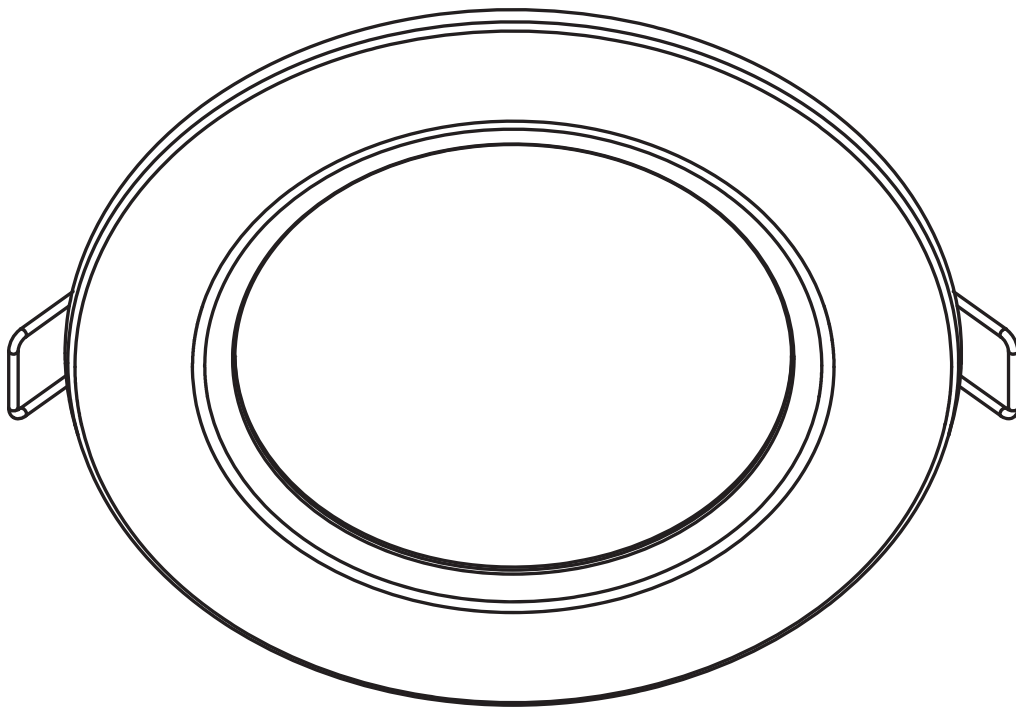

ENERGETIC
L I G H T I N G

CCT Selectable Slim Downlight Flushmount Ceiling Fixture

Installation Instructions



Intertek

ATTACH YOUR RECEIPT HERE

Item Number _____ Purchase Date _____

Questions, problem, missing parts? Before returning to your retailer, call our customer service department at 1-866-492-6566

PACKAGE CONTENTS

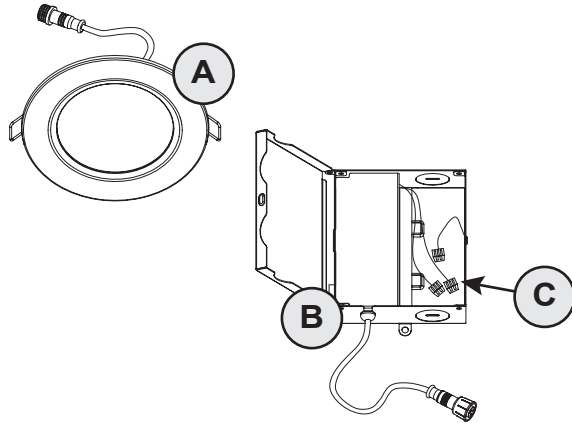

Parts	Item Name	Qty
A	Downlight	1
B	Power supply junction box	1
C	Wire connectors (pre-install)	1

SAFETY INFORMATION

Please read and understand this entire manual before attempting to assemble, operate or install the product. Failure to do so could lead to electric shock, fire or other injuries that could be hazardous or even fatal.

- Be sure the electricity to the wires you are working on is shut off. Either remove the fuse or turn off the circuit breaker.
- Changes or modifications not expressly approved by the party responsible for compliance could void the user's authority to operate the equipment.
- This fixture is suitable for dimming only when connected to a triac dimming system.

CAUTION:

- The fixture body is one piece. Do not disassemble it.
- This fixture is dimmable with most phase-cut triac dimmer switches, for the latest compatibility list, please visit www.energeticlighting.com.

NOTICE:

- This device complies with Part 15 of the FCC Rules. Operation is subject to the following two conditions: (1) This device may not cause harmful interference, and (2) this device must accept any interference received, including interference that may cause undesired operation.
- This equipment has been tested and found to comply with the limits for a Class B digital device, pursuant to part 15 of the FCC Rules. These limits are designed to provide reasonable protection against harmful interference in a residential installation. This equipment generates, uses and can radiate radio frequency energy and, if not installed and used in accordance with the instructions, may cause harmful interference to radio or television reception, which can be determined by turning the equipment off and on. The user is encouraged to try to correct the interference by one or more of the following measures:
 - Reorient or relocate the receiving antenna.
 - Increase the separation between the equipment and the receiver.
 - Connect the equipment into an outlet on a circuit different from that to which the receiver is connected.
 - Consult the dealer or an experienced radio/TV technician for help.

SAFETY INFORMATION

WARNING

- Risk of fire or electric shock. LED Retrofit Kit installation requires knowledge of luminaries electrical systems. If not qualified, do not attempt installation. Contact a qualified electrician.
- Disconnect power at fuse or circuit breaker before installing or servicing.
No user serviceable parts inside. To avoid electrical shock, do not disassemble product.
- This product is not intended for use in emergency light fixtures or exit signs. Not for use where exposed directly to the weather or water.
- This product contains a chemical known to the state of California to cause cancer, birth defects or other reproductive harm.

PACKAGE CONTENTS

Before beginning assembly of product, make sure all parts are present. Compare parts with package contents list and hardware contents list. If any part is missing or damaged, do not attempt to assemble the product.

Estimated Assembly Time: 10 minutes

INSTALLATION INSTRUCTIONS

1a. Mounting surface : New construction

Depending on the model number shown below, cut the appropriate hole size using the following diameter:

- Model E2DLF8T4-92750 : cut 4" diameter opening
- Model E2DLF11T6-92750 : cut 6" diameter opening
- Model E2DLF25T8-92750 : cut 8" diameter opening

Ensure that ceiling has access to power supply lead suitable for connection to a 1/2 inch trade-size knockout.

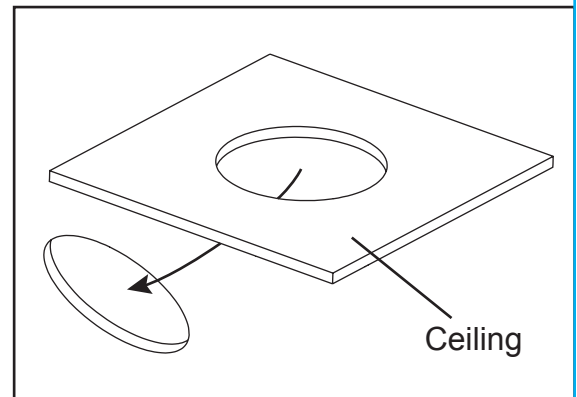

2a. Before proceeding to the next step, set the desired color temperature (CCT), using the slide switch on the driver located inside the power supply junction box (B). CCT can be changed from 2700K, 3000K, 3500K, 4000K, or 5000K.

Remove one of the knockouts for connection to building supply line.

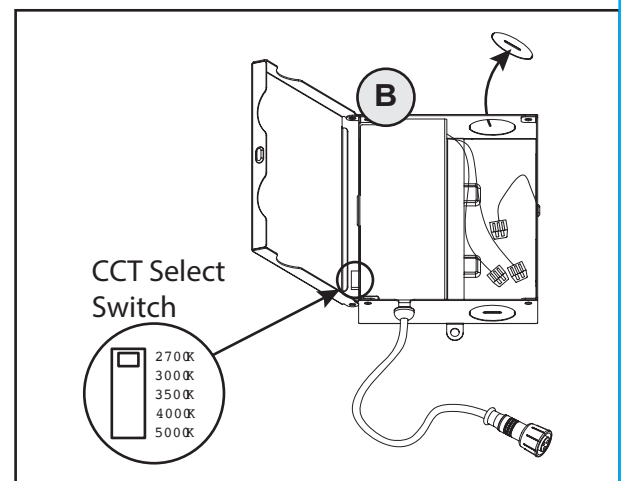

INSTALLATION INSTRUCTIONS

- 2b. Connect the building supply line through the conduit knockout using a suitable knockout adapter and make the appropriate wire connections by inserting the building wire into the pre-installed wire connectors (C) within the power supply junction box (B)

Black (line) to black, White (neutral) to white, and Green (ground) to green or bare metal copper building line.

With supply line connected, locate a suitable spot for the power supply junction box (B) and fasten to a secure surface or building structure.

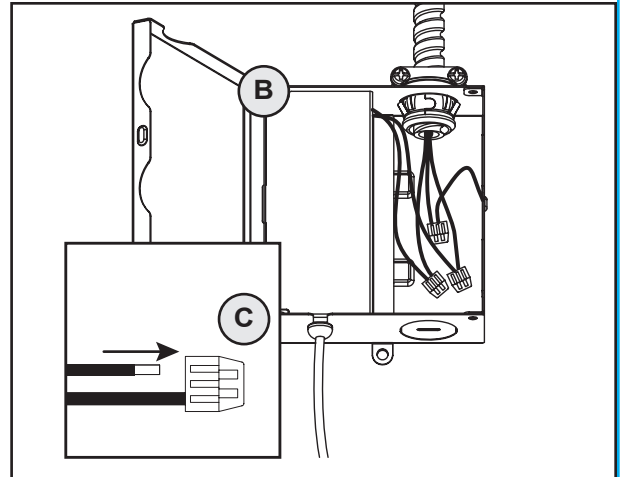

3. Connect the downlight to the junction box (B) and the downlight fixture (A) by means of connecting the connectors and twisting the thread ring to fully secure.

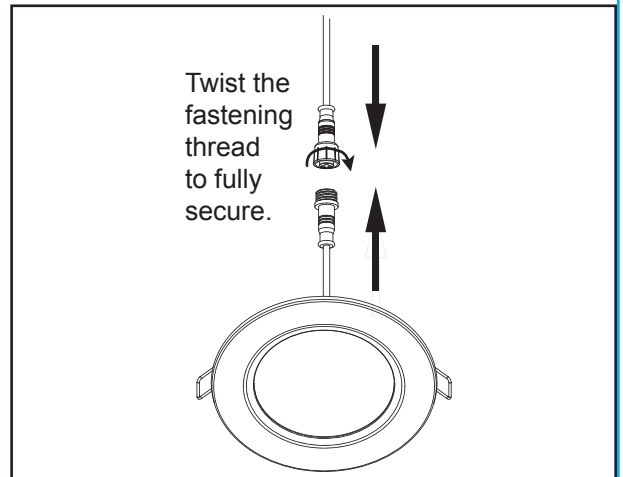

4. Fold up the tension arms on both sides of the downlight body (A) while inserting the body through the mounting surface opening, allowing the tension in the arms to fold down and catch the back surface until the front surface is flush against the mounting surface.

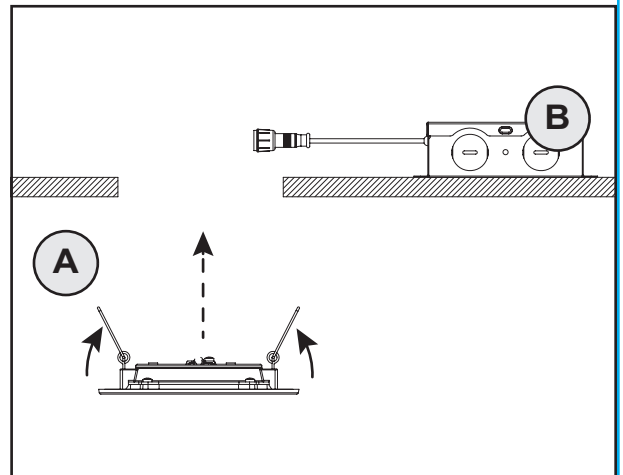

INSTALLATION INSTRUCTIONS

5. Once everything is secured test by turning on light.

Trouble shoot if need be. Refer below

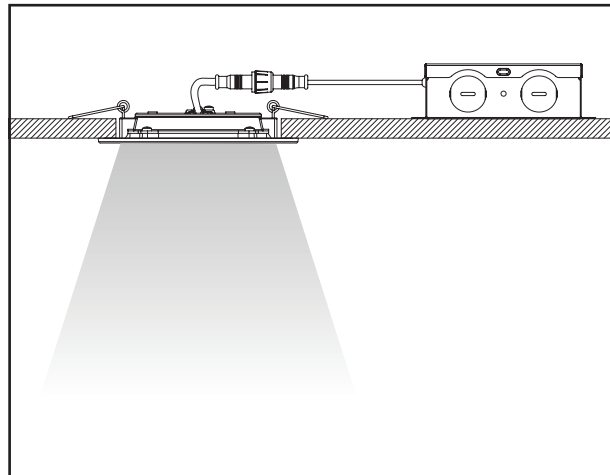

CARE AND MAINTENANCE

Clean with a mild, non-abrasive glass cleaner and soft cloth. Do NOT use solvents or cleaners containing abrasive agents. When cleaning the fixture, make sure the power is turned off, and any liquid spray should be applied to the cleaning cloth and not sprayed directly onto the fixture itself.

TROUBLESHOOTING

PROBLEM	POSSIBLE CAUSE	CORRECTIVE ACTION
Fixture does not light.	1. Power is off. 2. Incorrect wire connection. 3 Defective wall switch.	1. Check circuit breaker or wall switch. 2. Check wire splices. 3. Replace switch.
Circuit breaker trip when light is turned on.	Crossed wire or power wire is grounded out.	Verify wires are correctly connected.

WARRANTY

This fixture is warranted to perform free from defects for five(5) years. If it fails to do so, you may return it with proof of purchase to 13445 12th St., Chino, CA 91710 for replacement.

--	--